

# ADJUSTABLE STEEL GANTRY CRANE - KNOCKDOWN - AHSN-4-10-12

APPROX WEIGHT: 814.40 lbs.  
DOES NOT INCLUDE WEIGHT OF POWER OR PACKAGING!!!

\*\*\* ANY ADDITIONS, DELETIONS, OR OMISSIONS MUST BE CORRECTED ON THIS DRAWING AS THIS DRAWING WILL BE CONSIDERED ALL INCLUSIVE \*\*\*

ALL GRAPHICS PROVIDED ARE FOR REFERENCE ONLY. IF CERTAIN DIMENSIONS ARE CRITICAL PLEASE VERIFY THOSE DIMENSIONS WITH YOUR SALESPERSON

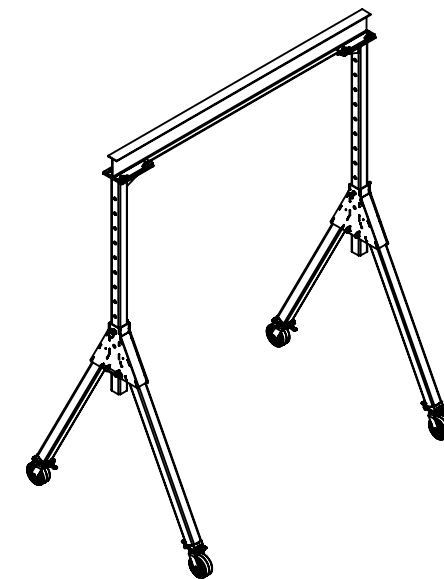
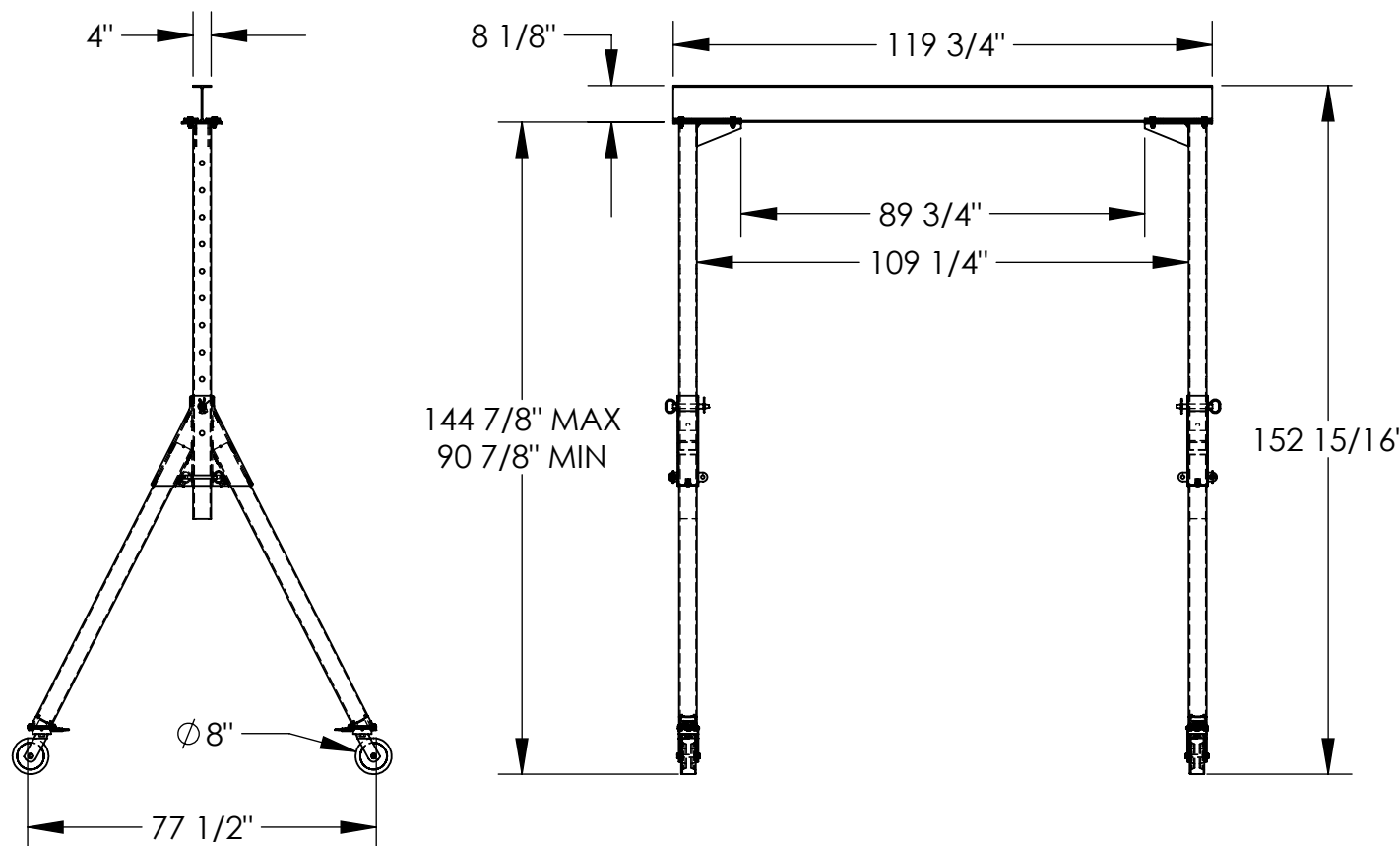

3D VIEW FOR REFERENCE ONLY

DIMENSION TOLERANCE  $\pm 1/4"$

## STANDARD FEATURES

MODEL NUMBER IS AHSN-4-10-12

CAPACITY IS 4,000 LBS.

BASE WIDTH IS 77 1/2"

MAX OVERALL HEIGHT IS 152 15/16"

I-BEAM HEIGHT IS 8 1/8"

I-BEAM FLANGE WIDTH IS 4"

OVERALL I-BEAM LENGTH IS 119 3/4"

USABLE I-BEAM LENGTH IS 89 3/4"

ADJUSTABLE UNDER I-BEAM HEIGHT

144 7/8" MAX

90 7/8" MIN

HEIGHT IS ADJUSTABLE IN 6" INCREMENTS

CASTERS: (4) Ø8" X 3" WIDE PHENOLIC

SWIVEL CASTERS WITH FOUR

LOCKING POSITIONS

## SPECIAL FEATURES

NONE

APPROVAL

I, THE UNDERSIGNED, AGREE THAT THE PRODUCT AS REPRESENTED SATISFIES DESIGN AND DIMENSION REQUIREMENTS. I ALSO ACKNOWLEDGE MY DUTY TO CONFIRM PRODUCT AND INSTALLATION COMPLIANCE WITH ALL APPLICABLE FEDERAL, STATE AND LOCAL REGULATIONS AND STANDARDS.  
**UNITS REQUIRING APPROVAL DRAWINGS OR MODIFIED ARE NON-RETURNABLE**

[ ] As drawn [ ] As marked

Signed: \_\_\_\_\_ Date: \_\_\_\_\_

Printed Name: \_\_\_\_\_

LEAD TIME WILL START UPON RECEIPT OF SIGNED APPROVAL DRAWING

DISTRIBUTOR'S NAME:

VESTIL MANUFACTURING

DRAWN BY: DLS

DATE: 06/30/14

REFERENCE: X

SCALE: 1:42

QUOTED LEAD TIME: X

QUOTE # X

P.O.# X

W.O.# X

SALES: X

FILE NAME:

28-007-310